





About the Company

- Team
- Production and equipment
- Certificates and awards

4

Products

- Translucent wooden structures
- Translucent wooden structures with aluminium protection
- Wooden front doors
- Translucent aluminium structures
- Winter gardens

8

Pato life

14

New generation of profiles

17

Patio Life automatic sliding systems

18

Pilkington Profilit™. Glazing system for original architectural solutions

19

Services/Services

20

Partners/Clients

22

Gallery

23

October 2, 1995, the production facilities of Marconi LTD were established in Odessa. Three years later, in 1998, the representative office "Marconi — Capital" Trading House was opened in Kyiv. Having a 15-year experience in the Ukrainian market, Marconi has gained a reputation of an exclusive producer of translucent glulam structures of the highest quality. Our company's specialisation is the design and production of translucent structures for windows, doors, facade systems, and winter gardens.

In 2000, the department of innovative technologies was formed ensuring the implementation of the most complex projects and architectural solutions. The main task of the department is to analyse the industry technologies on the world market for further improvement of the company's products and services, in particular, for the creation of new design solutions, modernisation of existing mechanisms, development of installation and paint coating technologies. This allows us to produce high-quality structures with bigger weight and dimensions, and to install them in aggressive climate environments, while providing 10-year warranty.

Each Marconi product is a branded article. At all stages, from designing to installation, we apply the highest operational standards because that's the way we understand our business aimed not only to be commercially successful, but also to symbolise home prosperity, cosiness and warmth.



Sincerely, General Director
Ivan Balev

Team

The key to the success of our company is highly qualified personnel.

Currently, Marconi has more than 100 experienced professionals who constantly improve their skills and achieve higher levels of competence due to experience exchanges with German and Austrian enterprises.



Dukov Marin Ivanovich
Development and Innovation Director
Professional experience: 29 years



Klepka Vasily Vasilyevich
Production Director
Professional experience: 24 years



Sayapin Vladimir Mikhailovich
Chief Designer
Professional experience: 43 years



Krainyukov Konstantin Viktorovich
Technical Director
Professional experience: 21 years

Production and equipment

Today the Marconi company is a modern high-tech production enterprise with the facilities of more than 10,000 m². The company's annual outcome is from 150 to 200 individual projects and over 8000 m² of products.

We use modern equipment manufactured by such leaders of woodworking equipment and technology sector as Weinig (Germany), Felder (Austria), Rojek (Czech Republic), Leitz (Germany), Vivutex, Scheer, SATA (Germany).

At present, all our workshops are equipped with temperature and humidity monitoring systems, which are one of the most important factors for ensuring a long-term product warranty.

Constant investments in new technologies and equipment ensure the highest quality of Marconi's translucent wooden structures.



Certificates and awards

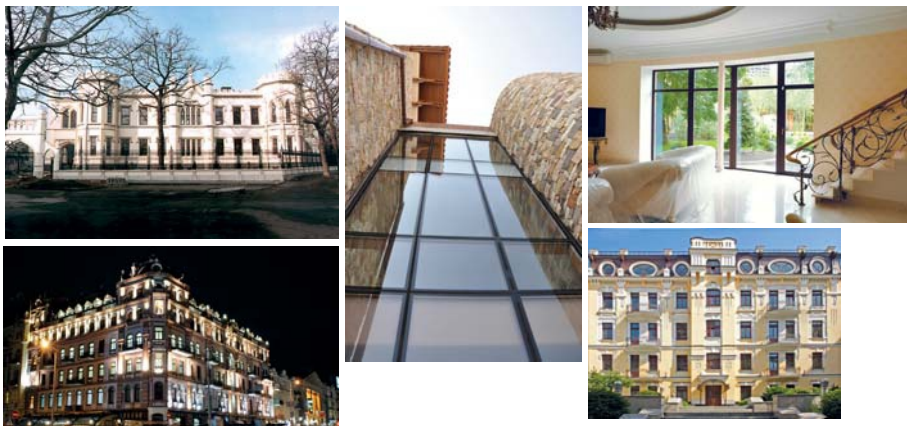

The quality of our products is confirmed by certificates, diplomas of international exhibitions and, of course, feedback from our clients. In **2005**, the Marconi company's products entered in the register of the best Ukrainian products. In **2008**, the Marconi company became the winner of the national contest "100 best products of Ukraine". Marconi products were awarded with "Excellence in Quality" and "The Best Product of the Year" marks several times.

In **2010**, the Marconi's production was verified and certified by the German company Remmers. Marconi became the only company on the CIS territory, which received the right to provide a **10-year warranty** on paint coatings.



Translucent wooden structures

Marconi translucent wooden structures is the optimal combination of mechanical and manual wood processing using the best wood species: American oak, mahogany (Meranti), pine, larch, as well as exotic species.

Currently there are no limitations on the shape of wooden windows. Translucent wooden constructions embody the living natural beauty perfectly complementing both modern and classical interiors.



Oak

The valuable specie, famous for its special texture with a clearly distinguished pattern of fibres. Oak is the most resistant to mechanical impacts and it has a high tenacity and hardness.



Meranti

The tropical specie with high thermal and sound insulation properties. Its characteristic feature is the durability of wood in any climatic conditions. This specie has a beautiful and rich texture with an expressive pattern of fibres.



Pine

The most widely used specie of a yellowish-red or pale yellow colour. Its pros are lightweight, durability, and low thermal conductivity.

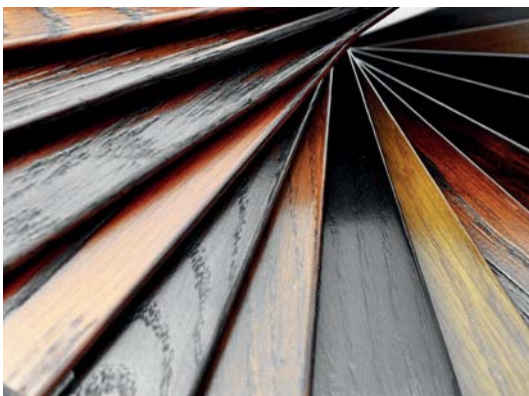

Paint coating

Marconi produces translucent wooden structures using the latest four-layer coating technology of the Remmers company (Germany).

This impregnation protects the wood from blueing, mold, rot, and fungi. The primer from alkyd resin emulsions and acrylic dispersions ensures the required colour shade and prepares the wood surface for good adhesion of the coating. Being water-based, all layers of the coating are environmentally friendly. Tests of such coating showed the highest coefficient of elasticity, water vapour permeability, gloss stability, adhesion strength, and water impermeability. Close cooperation with Remmers allows us to use almost the entire range of colours.

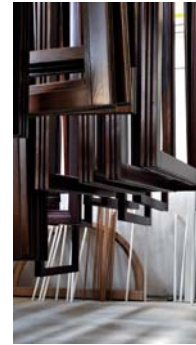

Insulated glazing

80% of the product's efficiency depends on the insulated glazing quality. Long-term partnerships with leading manufacturers of glass and glazing, such as Pilkington (England), Saint Gobain (France) and Guardian (USA), are a guarantee of the highest quality of our products designed applying the latest technology.

Advantages of translucent wooden structures

- Natural material with elegant appearance
- Environmentally friendly
- High frost resistance
- Low thermal and sound conductivity
- High tenacity
- Low coefficient of thermal linear expansion
- Maintainability

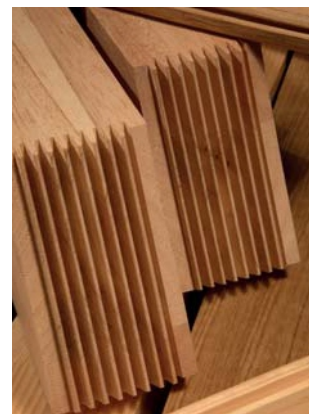

Translucent wooden structures with aluminium protection

Marconi offers translucent wooden structures combining the advantages of wood and aluminium. Our combined translucent structures are wooden products protected around the outer perimeter with the aluminium plates produced by famous manufacturers, such as BUG and Gutman. Such protection significantly increases the structure's service life and makes it durable because aluminium protects the wood from the adverse effects of the environment.

Advantages of wood-and-aluminium translucent structures

- Magnificent climatic protection
- Minimal care required
- Long service life (more than 100 years)
- Improved thermal insulation properties
- Individual colour and design solutions



IV 68 - Holz/Alu
Vertikalschnitt
RSB 25mm
Dichtung: 16,5mm
Verglasung: Nassverglasung

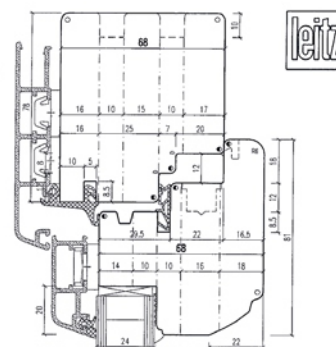

Verglasung: Trockenverglasung

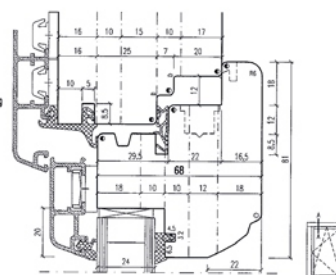

~ R 1.0
• R 1.5
○ R 2.0
○ R 2.5

gr. u. gep. 05.07.2008 WG
Schulzheim DN 34-1-1 B

L 161503342 DS 110 0
PZ01

Wooden front doors

Marconi front doors is a combination of individuality and your wishes. Our doors provide the access to the world of unlimited possibilities where the design options are endless.

We offer design services in cooperation with your architect, designer, and personally with you. Considering all requirements for safety, reliability and functionality, Marconi will manufacture high-quality front doors using individual profile systems of any complexity.

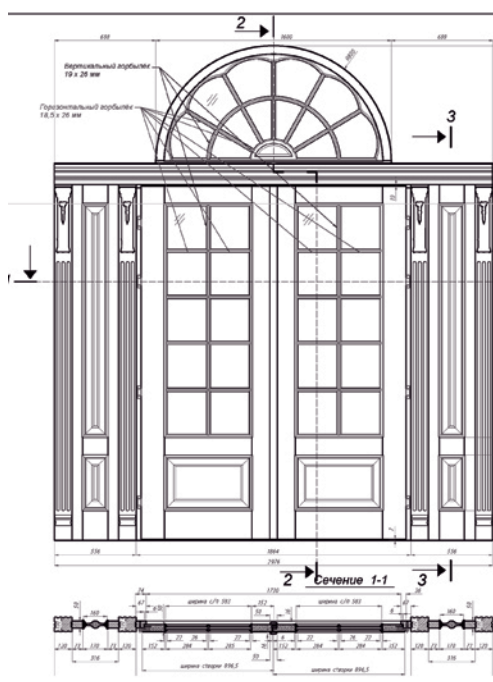

Translucent aluminium structures

In 2000, Marconi has mastered the production of translucent aluminium structures using profile systems of such companies as **Reynaers** (Belgium), **Schuco** (Germany), **Aluprof** (Poland), and others.

The production line for aluminium structures is equipped with **Pressta Eisele – Aluma** equipment (Germany – Slovakia).

Aluminium profile can serve more than 80 years. It does not require special care, it is resistant to corrosion, deformation, and other harmful effects of the environment.

Aluminium profiles can be coated by powder painting (RAL colour palette). Three options are available:

- One-color painting
- Two-colour painting (from the front and the outside)
- Wood grain pattern painting

The only drawback of aluminium structures is that they can not be restored.



Winter gardens



Winter gardens today is an integral part of any elite cottage. Marconi translucent winter garden structure is a high-quality engineering construction produced with application of forefront findings in the field of design, manufacturing and installation.

The frame is usually a steel or aluminium profile, but a wooden glulam frame can also be used.

It is well-known that winter gardens can be used all year round if the required ventilation is ensured. Marconi offers special window designs with automatic ventilation control, also enabling the ventilation in the roof area. The system can be built into various designs of winter gardens. The central control unit measures the temperature and compares it with individual settings. If the temperature rises, the ventilation window is opened by the electric drive until the temperature is normalized. In bad weather, the wind and rain sensors command the windows to close. The device can also operate according to pre-set time intervals independently of weather and temperature. In addition, the system with shading equipment is available.

Marconi offers the perfect solutions for the realisation of your dream to enjoy it all year round.

Patio Life. Ergonomics and aesthetics

Ergonomics

Despite the significant size and weight of a door leaf (up to 300 kg), special fittings ensure its easy control. Elements of locking mechanisms do not protrude from the frame and do not impede free and safe door leaf movement.

The Patio Life threshold is low and slightly inclined to the outside ensuring the comfortable access to the garden, balcony or terrace.

The Patio Life threshold is made of a special material with good thermal insulation properties.

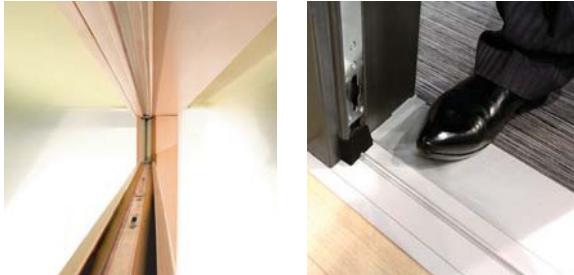

Aesthetics

The unique Marconi's offer for designs of houses with special aesthetic requirements is Patio Life door leaves with the solid glass outside surface and the inside surface of the frame preserving the warmth and nobility of natural wood.



Security

Security

Patio Life door leaf has anti-burglar protection around the entire perimeter in both the closed position and the vent position (left picture).



When the door handle is rotated 180°, the upper seal of the leaf is pressed, forming a slot for fresh air supply

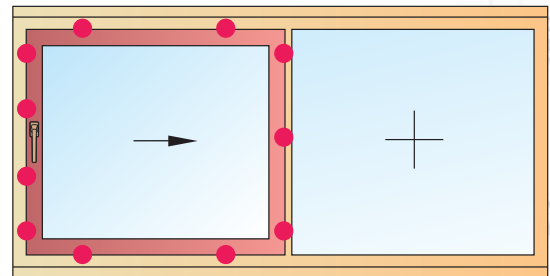

In this case, the leaf remains completely locked. This design solution allows fresh air to enter the room.

Features & Benefits

Features & Benefits

Structure dimensions:

- height up to 3 meters
- width up to 19 meters

Door opening dimensions:

- height up to 2.8 meters
- width up to 6.5 meters

Easy handling of the door leaf with a weight of up to 300 kg

Available outside lining with aluminium profile (aluminium protection)

Optional opening magnetic sensors (MVS) for Patio Life doors

Basic structure schemes

Basic structure schemes

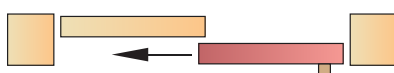

Scheme A DIN left (structure width up to 6.5 m)

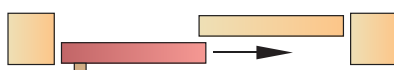

Additional structure schemes

Scheme C (structure width up to 13 m)



Scheme D (structure width up to 6.5 m)

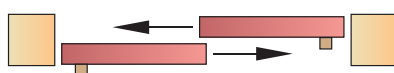

Scheme F (structure width up to 13 m)



Scheme G2 (structure width up to 9.8 m)

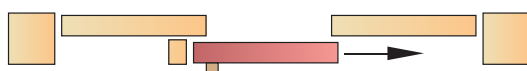

Scheme K (structure width up to 13 m)

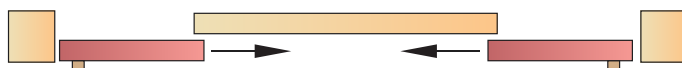

Scheme E (structure width up to 9.6 m)

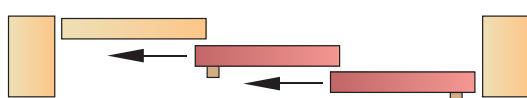

Scheme L (structure width up to 19 m)



Structure operation modes

Patio Life structure operation modes

The system can operate in three modes:

- closed (handle is in the "down" position),
- open (handle is in horizontal position),
- micro-ventilation mode (handle is in the "up" position).

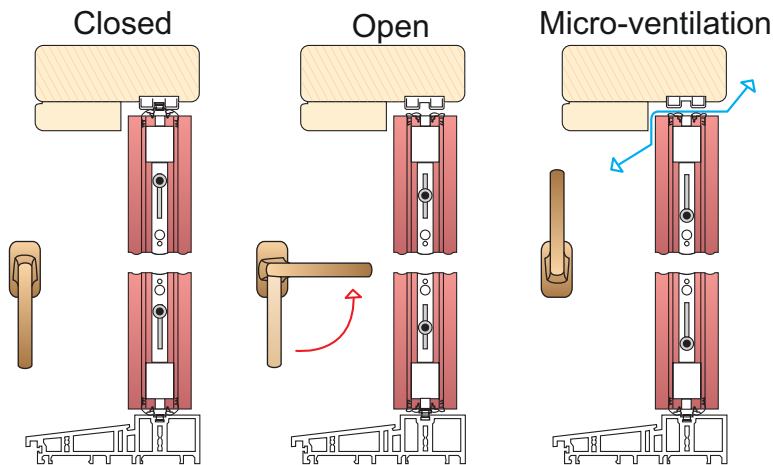

Three colour options are available for handles.



Colour options

A set of 22 standard colours of glossy and matte textures, as well as individual colour options are offered.



New generation of profiles

A new generation of European profiles has many significant benefits:

- Improved appearance aesthetics, both from inside and outside
- More efficient sealing
- No thermal bridges
- Insulated glazing unit is mortised into the frame by 10% deeper
- Increased thickness of glazing bead from 18 mm to 20 mm
- Increased angle of inclination of horizontal surfaces, allowing to prolong the life time of the coating

Characteristics of profiles

IV68:

- * 68x80 mm
- * Heat resistance coefficient $R=0.68 \text{ m}^2 \text{ } ^\circ\text{C/W}$
- * Maximum thickness of insulated glazing unit 34 mm

IV78:

- * 78x80 mm
- * Heat resistance coefficient $R=0.74 \text{ m}^2 \text{ } ^\circ\text{C/W}$
- * Maximum thickness of insulated glazing unit 36 mm

IV90:

- * 90x80 mm
- * Heat resistance coefficient $R=0.85 \text{ m}^2 \text{ } ^\circ\text{C/W}$
- * No. 1 for houses with passive heating
- * Maximum thickness of insulated glazing unit 44 mm

Marconi is the only company in Ukraine that uses the IV90 profile.

IV68 Holzfenster
Vertikalschnitt

Achsmaß: 13,15mm
S+Z Gleichtellung (2flach)
Schlennefals: 22mm
5mm Flügel-Falzdichtung
Glasleitedichtung:
Deventer S 6867

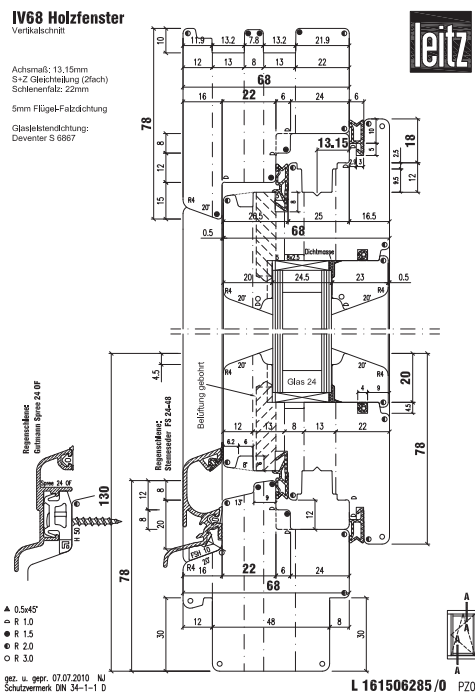

▲ 0.5x45°
● R 1.0
● R 1.5
● R 2.0
● R 3.0
gez. u. gepr. 07.07.2010 NJ
Schutzvermerk DN 34-1-1 D

L 161506285/0 PZ01

IV90 Holzfenster
Vertikalschnitt

Achsmaß: 13,15mm
S+Z Gleichtellung (2flach)
Schlennefals: 32mm
5mm Flügel-Falzdichtung
Glasleitedichtung:
Deventer S 6867

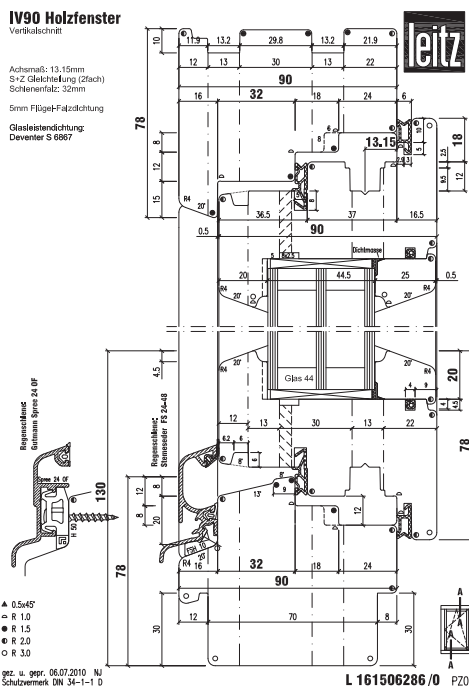

▲ 0.5x45°
● R 1.0
● R 1.5
● R 2.0
● R 3.0
gez. u. gepr. 06.07.2010 NJ
Schutzvermerk DN 34-1-1 D

L 161506286/0 PZ01

IV78 Holzfenster
Vertikalschnitt

Achsmaß: 13,15mm
S+Z Gleichtellung (2flach)
Schlennefals: 32mm
5mm Flügel-Falzdichtung
Glasleitedichtung:
Deventer S 6867

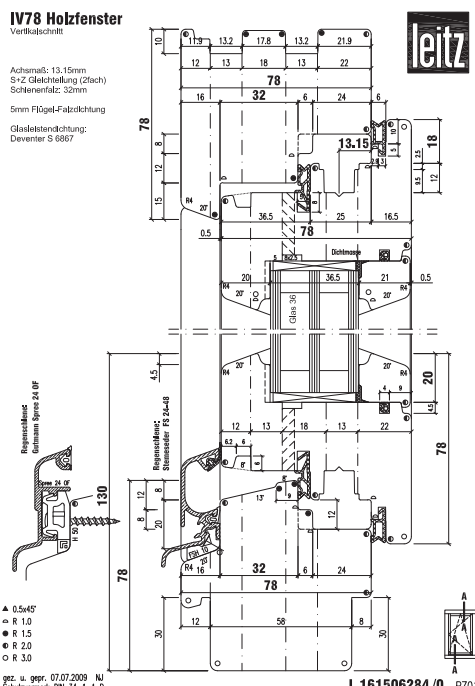

▲ 0.5x45°
● R 1.0
● R 1.5
● R 2.0
● R 3.0
gez. u. gepr. 07.07.2009 NJ
Schutzvermerk DN 34-1-1 D

L 161506284/0 PZ01

Patio Life automatic sliding systems

The easiest way to open a heavy door

- Comfortable and fully automatic operation of large doors
- Aesthetic appearance of the system due to concealed installation of the electric drive in the floor
- Safe ventilation: system remains anti-burglar protected in the micro-ventilation mode
- The best fittings in the market
- The smallest engine in comparison with other HS systems
- Easy access to the engine
- Two simple ways to control: the remote control and the built-in wall button

Safety of Patio Life automatic sliding systems

- All cables and engines of the system are safely closed in the installation boxes
- Positive stop
- Additional sensors eliminate the risk of human injury
- The speed of the leaf is only 0.9–0.11 m/s
- The system can be manually controlled manual use in the absence of electricity



Pilkington Profilit™.

Glazing system for original architectural solutions

Pilkington Profilit™ is the profiled channel glass, which is increasingly being used in modern architecture. The use of this product does not require any additional supporting structures, thus widening the design potential. Due to this, the glass is used in various innovative solutions.

Scope of application The main scope of application of the system is facades, staircases, roofs, internal glass partitions in commercial, sports, and industrial facilities, as well as in public buildings, such as schools, museums, and galleries.



Efficiency and safety for the environment The system allows avoiding additional lighting during the day-time. If double-glazed, Pilkington Profilit™ can provide sufficient insulation from both overheating in the summer and overcooling in the winter, helping to reduce the overall energy consumption.



Noise protection Double glazing reduces the noise level by approximately 38–41 dB.

Safety The system's mechanical strength has been improved. An additional advantage is an increase in the maximum installation dimensions of the glass. Heat treatment is applied.

Thermal insulation Thanks to low emission coating, Pilkington Profilit™ Plus 1.7 glass keeps the heat inside. Optimal thermal insulation results in lower energy consumption.



Services/Maintenance



Marconi company is focused on individual, rather than bulk orders. We specialise in glazing of private cottages.

As soon as the product has been installed, the Marconi company pays special attention to its service and maintenance.

Cooperation with Marconi means:

- Professional advice
- Timely task completion
- Engineering support at the design stage
- Information support for construction workers
- Dismantling and installation works
- Works can be completed 24/7 in any place in Ukraine
- Mobility
- Quality assurance

Warranty services

Each product of the Marconi company has a passport and entitled to warranty service from 5 to 10 years.

Service support for products includes a set of services aimed at ensuring the proper functioning of the product during the warranty period. Marconi does not charge any payment for such services under normal use of the products described in the passport.

Once a year during the warranty period, the manager of Marconi service centre agrees with the client the date of the visit for the maintenance of installed products.

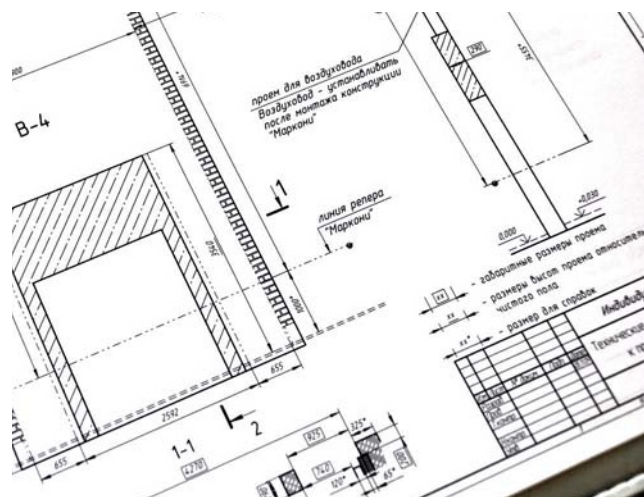

Post-warranty services

Post-warranty services include repair works to eliminate possible faults in the product operation and a set of post-warranty services as an extra service. Any post-warranty services are provided on the client's demand.

10-year warranty

Currently, the Marconi company is the only enterprise in the CIS territory entitled to provide a 10-year warranty on paint coatings of the Remmers company (Germany).

Partners and clients

Partners



Clients

- Architectural Studio "Bilas design"
- Outlet-town "Manufactory"
- Architectural Studio "dreamdesign"
- UkrAVTO (Kyiv)
- Odessa cognac factory "Shustov"
- Architectural Studio "Plan"
- Architectural Studio "ADS"
- Otrada development
- Supermarket chain "Velyka Kyshenya"
- Mercedes dealership
- Toyota dealership
- Nissan Ukraine dealership
- Ukrainian-French Joint Venture "Osnova-Solsif"
- Construction company "French Boulevard Building"
- Commercial company "VeSTT"
- Prominvestbank
- The bank "Pivdenny"
- AO Kyivenergo
- Odessa Port Plant
- Construction company "Hi-Raise construction"
- OOO "Construction company"
- OOO "Elite — Sroy"
- OOO "Sofor"
- AK Engineering
- The Bank "Finance and Credit"

Gallery

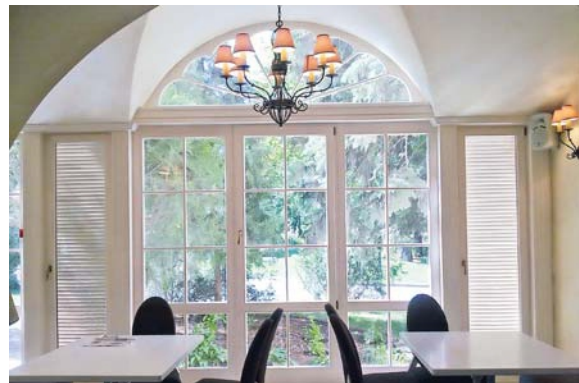

















Designer V Faynblat



**Staronavodnitskaya St. 13, office 126a,
Kyiv, Ukraine, 01015
Tel.: + 38(044)332-80-89
Tel.:+38(044)337-73-52
MTS: +38(050)335-85-83
e-mail:office@marconi.kiev.ua
www.marconi.kiev.ua**